

# WOOD DESTROYING PESTS AND ORGANISMS INSPECTION REPORT

BUILDING NO. <b>2925</b>	STREET, CITY, STATE, ZIP <b>Hildalgo Court, San Jose CA 95124</b>	Date of Inspection <b>1/6/2012</b>	No. of Pages <b>6</b>
-----------------------------	--	---------------------------------------	--------------------------



305 Vineyard Town Center #326  
Morgan Hill, CA 95037-5674  
408-927-6300 or 650-322-5785  
FAX 408-997-0243  
Email officeadmin@tylertermite.com

Firm Registration No. <b>PR 4359</b>	Report No. <b>18637</b>	Escrow No.
Ordered By: Gillmor & Associates 1201 Franklin Mall Santa Clara, CA 95050 Attn: Lisa Gillmor	Property Owner/Party of Interest McDonald 2925 Hildalgo Court San Jose, CA 95124  Gillmor & Associates 1201 Franklin Mall Santa Clara, CA 95050	Report Sent To: Gillmor & Associates 1201 Franklin Mall Santa Clara, CA 95050 Attn: Lisa Gillmor

COMPLETE REPORT       LIMITED REPORT       SUPPLEMENTAL REPORT       REINSPECTION REPORT

General Description: One story wood/stucco/brick framed stucco exterior, single family residence, occupied with an attached two car garage.	Inspection Tag Posted: Garage
	Other Tags Posted: None noted

An inspection has been made to the structure(s) shown on the diagram in accordance with the Structural Pest Control Act. Detached porches, detached steps, detached decks and any other structures not on the diagram were not inspected.

Subterranean Termites       Drywood Termites       Fungus/Dryrot       Other Findings       Further Inspection   
If any of above boxes are checked, it indicates that there were visible problems in accessible areas. Read the report for details on checked items.

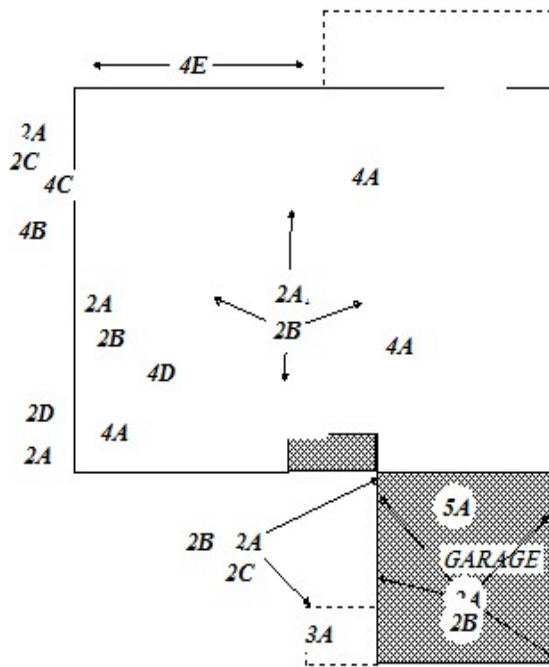

*DIAGRAM NOT TO SCALE*

FRONT

Inspected by Mark Rodriguez      State License No. OPR 9463      Signature

You are entitled to obtain copies of all reports and completion notices on this property reported to the Structural Pest Control Board during the preceding two years. To obtain copies contact: Structural Pest Control Board, 2005 Evergreen Street, Suite 1500, Sacramento, California 95815.  
NOTE: Questions or problems concerning the above report should be directed to the manager of the company. Unresolved questions or problems with services performed may be directed to the Structural Pest Control board at (916) 561-8708, or (800) 737-8188 or www.pestboard.ca.gov.      43M-41 (Rev. 10/01)

2925

Hildalgo Court, San Jose CA 95124

1/6/2012

18637

BUILDING NO.

STREET, CITY, STATE, ZIP

INSPECTION DATE

REPORT NO.

THIS IS A STRUCTURAL PEST CONTROL INSPECTION REPORT NOT A BUILDING INSPECTION REPORT, THEREFORE NO OPINION IS BEING RENDERED REGARDING THE STRUCTURAL INTEGRITY OF THE BUILDING. THE FOLLOWING AREAS WERE NOT INSPECTED, AS INDICATED IN SECTION #1990, PARAGRAPH (j) OF THE STRUCTURAL PEST CONTROL ACT AND RULES AND REGULATIONS FURNISHED INTERIORS, INACCESSIBLE ATTICS, INSULATED ATTICS AND PORTIONS THEREOF, THE INTERIOR OF HOLLOW WALLS SPACES BETWEEN A FLOOR OR PORCH DECK AND THE CEILING OR SOFFIT BELOW, STALL SHOWERS OVER FINISHED BUTTRESSES AND SIMILAR AREAS TO WHICH THERE IS NO ACCESS WITHOUT DEFACING OR TEARING OUT LUMBER, MASONRY AND FINISHED WORK, BUILT-IN CABINET WORK, FLOOR BENEATH COVERINGS, AREAS WHERE STORAGE CONDITIONS OR LOCKS MAKE INSPECTION IMPRACTICAL. NO STORAGE IS MOVED FROM BENEATH THE SINKS OR FROM THE INTERIOR OF ANY CLOSETS AND ARE CONSIDERED INACCESSIBLE AREA.

NOTICE :The Structural Pest Control Board encourages competitive business practices among registered companies. Reports on this structure prepared by various registered companies should list the same findings (i.e. termite infestations termite damage, fungus damage, etc.). However, recommendations to correct these findings may vary from company to company. Therefore, you may wish to seek a second opinion since there may be alternative methods of correcting the findings listed on this report that may be less costly.

THE EXTERIOR SURFACE OF THE ROOF WILL NOT BE INSPECTED. IF YOU WANT THE WATER TIGHTNESS OF THE ROOF DETERMINED, YOU SHOULD CONTACT A ROOFING CONTRACTOR WHO IS LICENSED BY THE CONTRACTORS STATE LICENSE BOARD.

IF A SEPARATE REPORT HAS BEEN REQUESTED, IT IS DEFINED AS SECTION 1 & SECTION 2 CONDITIONS EVIDENT ON THE DATE OF INSPECTION.

SECTION 1:

CONTAINS ITEMS WHERE THERE IS EVIDENCE OF ACTIVE INFESTATION, INFECTION OR CONDITIONS THAT HAVE RESULTED IN OR FROM INFESTATION OR INFECTION. SECTION 2: SECTION 2 ITEMS ARE CONDITIONS DEEMED LIKELY TO LEAD TO INFESTATION OR INFECTION, BUT WHERE NO VISIBLE EVIDENCE OF SUCH WAS FOUND.

FURTHER INSPECTION: FURTHER INSPECTION ITEMS ARE DEFINED AS RECOMMENDATIONS TO INSPECT AREAS WHICH, DURING THE ORIGINAL INSPECTION, DID NOT ALLOW THE INSPECTOR ACCESS TO COMPLETE THE INSPECTION AND CANNOT BE DEFINED AS SECTION 1 OR SECTION 2.

"NOTICE : The charge for services that this company subcontracts to another registered company may include the companies charges for arranging and administering such services that are in addition to the direct costs associated with paying the subcontractor. You may accept Tyler Termite Control Inc's bid or you may contract directly with another registered company licensed to perform work.

If you choose to contract directly with another registered company, Tyler Termite Control Inc. will not in any way be responsible for any act or omission in performance of work that you directly contract with another to perform."

2925

Hildalgo Court, San Jose CA 95124

1/6/2012

18637

BUILDING NO.

STREET, CITY, STATE, ZIP

INSPECTION DATE

REPORT NO.

**2. Drywood Termites:**

- ITEM 2A Evidence of drywood termites was noted at the area(s) indicated on the diagram ( Garage/subarea/exterior). Infestation extends into inaccessible area(s).

RECOMMENDATION: Fumigate the entire structure with Vikane or Zythor gas and Cloropicrin for the complete eradication of drywood termite infestation. This company will furnish all necessary instructions for the owners or concerned parties prior to the fumigation date scheduled.

NOTE: OUR BID DOES NOT INCLUDE ANY PREP WORK THAT MAY BE NECESSARY. ALL INSTRUCTIONS MUST BE THOROUGHLY READ BY ALL PARTIES. FAILURE TO COMPLETE FUMIGATION PREP OR RETURNING PAPERS PRIOR TO FUMIGATION DATE MAY RESULT IN CANCELLATION AND/OR RESCHEDULING.

\*\*\*\*\* This is a Section 1 Item \*\*\*\*\*

- ITEM 2B Drywood termite pellets were noted at the areas as outlined in item 2A where indicated on the diagram.

RECOMMENDATION: Remove and /or mask all accessible termite pellets.

\*\*\*\*\* This is a Section 1 Item \*\*\*\*\*

- ITEM 2C Minor nonstructural Drywood termite damage noted at rafter extensions and barge rafter.

RECOMMENDATION :Remove damage and repair as necessary with appropriate filler material . Reseal and prime paint.

\*\*\*\*\* This is a Section 1 Item \*\*\*\*\*

- ITEM 2D Drywood termites have damaged the rafter extensions at areas indicated on diagram.

RECOMMENDATION:Remove and/or reinforce damaged extensions as necessary.

NOTE: If damage extends into the roof sheathing a supplemental report and cost estimate will be submitted.

\*\*\*\*\* This is a Section 1 Item \*\*\*\*\*

**3. Fungus/Dryrot:**

- ITEM 3A The wood overhang 4x6 support post at area indicated were noted to be in soil contact and fungus damaged.

RECOMMENDATION: Remove damaged support posts and install either pressure treated material or masonry footing . Lower soil level as necessary.

\*\*\*\*\* This is a Section 1 Item \*\*\*\*\*

**4. Other Findings:**

- ITEM 4A Fungus infected Cellulose debris was noted in the subarea where indicated on the diagram.

RECOMMENDATION :Remove the cellulose debris of a rakable size from the subarea and dispose of.

\*\*\*\*\* This is a Section 1 Item \*\*\*\*\*

- ITEM 4B Vent screen(s) were noted broken or missing where indicated on diagram.

RECOMMENDATION:Replace the broken or missing vent screens.

\*\*\*\*\* This is a Section 2 Item \*\*\*\*\*

2925

Hildalgo Court, San Jose CA 95124

1/6/2012

18637

BUILDING NO.

STREET, CITY, STATE, ZIP

INSPECTION DATE

REPORT NO.

**4. Other Findings:**

ITEM 4C Hairline stress cracks or missing /broken stucco noted at areas where indicated on diagram.

RECOMMENDATION :Refinish or seal area(s) noted.

\*\*\*\*\* This is a Section 2 Item \*\*\*\*\*

NOTE: PORTIONS OF THE SUBAREA ARE INACCESSIBLE DUE HEATING DUCTS AND/OR PLUMBING LINES. REMOVAL OF DUCTS AND/OR PLUMBING IS IMPRACTICAL, NO OPINIONS ARE RENDERED AS TO THESE INACCESSIBLE AREAS.

NOTE: Portions of the attic are inaccessible for inspection due to air ducting ,heavy insulation, tight framing , lack of adequate clearance or heat . There is no economically practical method to make these area(s) accessible, however, they may be subject to attack by wood destroying pests or organisms. No opinion is rendered concernig this condition in these area(s).

ITEM 4D Missing and or cracked grout noted at master bath stall shower pan.

RECOMMENDATION :We advise regrouting,caulking and/or otherwise resealing these areas to eliminate this condition, and to protect against future possible water intrusion.

\*\*\*\*\* This is a Section 2 Item \*\*\*\*\*

NOTE :A standard water test was performed at master bath stall shower and did not reveal any leakage at shower pan.

ITEM 4E A marginal to below grade condition was noted at area indicated on diagram. This condition exists when the soil or concrete at the exterior wall is even with or above the top of the adjacent foundation mudsill or related framing.

RECOMMENDATION :It is recommended that flashing be installed if it does not already exist.

\*\*\*\*\* This is a Section 2 Item \*\*\*\*\*

**5. Further Inspection:**

ITEM 5A We were unable to inspect portions of the interior of the garage due to stored personal property.

RECOMMENDATION: The owner should move the storage away from the garage walls. At that time, we would return, inspect and make any additional recommendations. Our charge at this time is only for the inspection and any additional work required would be further cost.

\*\*\*\*\* Unknown Further Inspection Recommended \*\*\*\*\*

NOTE :Garage framing is finished and sealed. Framing is inaccessible to inspection. Further inspection would entail removal of finished materials. This will only be done upon request, authorization and at additional expense.

NOTE: Due to the building materials used on this structure.It may be difficult to match the existing mill patterns and materials used in the original construction.We will replace damaged wood members with material that resembles,as closely as possible ,the existing wood members with standard graded,readily available materials.

2925

Hildalgo Court, San Jose CA 95124

1/6/2012

18637

BUILDING NO.

STREET, CITY, STATE, ZIP

INSPECTION DATE

REPORT NO.

IF WITHIN 24 HOURS FOLLOWING APPLICATION YOU EXPERIENCE SYMPTOMS of dizziness, headache, reduced awareness, slowed movement, garbled speech or difficulty in breathing, leave the structure immediately and seek medical attention by contacting your physician or Poison Control Center 1-800-222-1222 and notify your pest control company. THE WARNING AGENT CHLOROPICIRIN, CAN CAUSE TEARING, RESPIRATORY DISTRESS AND VOMITING. ENTRY INTO THE SPACE DURING FUMIATION CAN BE FATAL SIMILAR TO COMMON SEASONAL ILLNESS COMPARABLE TO THE FLU, CONTACT YOUR PHYSICIAN OR POISON CONTROL CENTER AND YOUR PEST CONTROL OPERATOR IMMEDIATELY. FOR

FURTHER INFORMATION CONTACT ANY OR THE FOLLOWING :

TYLER TERMITE CONTROL INC. 408.927.6300

POISON CONTROL CENTER San Mateo County - (800) 523-2222, Santa Clara County - (800) 662-9886, Alameda County - (800) 523-2222

COUNTY HEALTH DEPARTMENT San Mateo County - (415) 363-4305, Santa Clara County - (408) 885-4200, Alameda County - (510) 567-6800

COUNTY AGRICULTURE COMMISSIONER San Mateo County - (415) 363-4700, Santa Clara County - (408) 299-2171, Alameda County - (510) 670-5232

THE STRUCTURAL PEST CONTROL BOARD - (916) 561-8700  
2005 Evergreen Street, Suite 1500 Sacramento, California 95815

PESTICIDES ARE THE PRODUCTS TYLER TERMITE CONTROL USES TO CONTROL THE TARGET PEST LISTED IN YOUR INSPECTION. PESTICIDES MAKE A BETTER LIFE FOR ALL OF US. THEY HELP CONTROL DISEASE CARRIERS THUS PROTECTING YOUR HEALTH AND PROPERTY. WHEN PROPERLY USED, PESTICIDES POSE NO PROBLEM TO MAN OR THE ENVIRONMENT. YOUR TYLER TERMITE CONTROL TECHNICIAN IS A STATE CERTIFIED APPLICATOR AND IS CONSTANTLY BEING UPGRADED BY OUR TRAINING SESSIONS. IF YOU HAVE ANY QUESTIONS PLEASE CALL THE FOLLOWING NUMBER 408.927.6300 "

STATE LAW REQUIRES THAT YOU BE GIVEN THE FOLLOWING INFORMATION:

CAUTION----- PESTICIDES ARE TOXIC CHEMICALS.

STRUCTURAL PEST CONTROL OPERATORS ARE LICENSED AND REGULATED BY THE STRUCTURAL PEST CONTROL BOARD, AND APPLY PESTICIDES WHICH ARE REGISTERED AND APPROVED FOR USE BY CALIFORNIA DEPARTMENT OF FOOD AND AGRICULTURE AND THE UNITED STATES ENVIRONMENTAL PROTECTION AGENCY. REGISTRATION IS GRANTED WHEN THE STATE FINDS THAT BASED ON EXISTING SCIENTIFIC EVIDENCE THERE ARE NO APPRECIABLE RISKS IF PROPER USE CONDITIONS ARE FOLLOWED OR THAT THE RISKS ARE OUTWEIGHED BY THE BENEFITS. THE DEGREE OF RISK DEPENDS UPON THE DEGREE OF EXPOSURE, SO EXPOSURE SHOULD BE MINIMIZED."

**MANUFACTURER**

Equity TC (Dow Elanco)

Termidor SC (BASF)

Invader HPX-20 (Waterbury)

Timbor (U.S. Borax)

**ACTIVE INGREDIENTS**

Chlorpyrifos

Fipronil

Phenyl Methylcarbamate

Boric Oxide

This company will reinspect repairs done by others within four months of the original inspection. A charge, if any, can be no greater than the original inspection fee for this inspection. The reinspection must be done within (10) working days of the request. The reinspection is a visual inspection and if inspection of concealed areas is desired, inspection of work in progress will be necessary. Any guarantees must be received from the parties performing repairs"

2925

Hildalgo Court, San Jose CA 95124

1/6/2012

18637

BUILDING NO.

STREET, CITY, STATE, ZIP

INSPECTION DATE

REPORT NO.

Thank you for choosing Tyler Termite Control Inc. If you have any question regarding your inspection report, please call your inspector Mark Rodriguez in the morning hours or late afternoon. Inspectors are out most of the day on inspections.